

SWIMMING POOL APPLICATION



PARADISE TOWNSHIP

APPLICANT: _____ DATE: _____

ADDRESS: _____ CITY: _____

PHONE #: _____ MAP - PARCEL: _____

COST of POOL: _____ ZONED: _____

CONTRACTOR: _____ Phone: _____

CONTRACTOR ADDRESS: _____

Workers compensation form must be on file for contractors, a licence may be required for your contractor.

TYPE: IN-GROUND: _____ ABOVE-GROUND: _____

SHAPE: _____ Sides: Hard _____ Soft _____

DIMENSIONS OR SIZE OF POOL: _____

Height of pool from ground level if above ground pool: _____
*If less than 4 foot (48 inches) in height a minimum 4 foot high fence is required meeting code.
If your above ground pool is 48 inches or higher, the ladder needs to lock up or be removable, decks attached must meet the fence requirements as described below.*

FENCE: MATERIAL: _____ HEIGHT: _____
A fence if installed must be at least 4 foot high from ground level, self closing gates, no opening larger than 2 inches

FILTERING UNIT: YES _____ NO _____
If installing electrical equipment to a pool it must meet the code standards and be wired direct with an approved breaker.

ELECTRIC WORK REQUIRES AN INSPECTION, COMPLETE ELECTRIC FORM AS WELL.

SIGNATURE: _____ DATE: _____

This application must be submitted with a detailed plot plan showing all buildings and structures on the lot and the location of the proposed pool, include all measurements.

Pools require inspections to be completed during construction phase for code compliance.

All inground and above ground (24" +) will require a building inspection and a Use and Occupancy Permit

Call PA One before any digging: 1-800-242-1776

Workers Compensation Insurance Coverage Information
(attach to building permit application)

A. The applicant is:

A contractor within the meaning of the Pennsylvania Workers Compensation Law

_____ Yes _____ No

If the answer is "yes", complete Sections B and C below as applicable.

B. Insurance Information:

Name of Applicant _____

Federal or State Employer Identification No. _____

Applicant is a qualified self-insurer for workers compensation.

_____ Certificate attached

Name of Workers Compensation Insurer _____

Workers Compensation Insurance Policy No. _____

_____ Certificate attached

Policy Expiration Date _____

C. Exemption:

Complete Section C if the applicant is a contractor claiming exemption from providing workers compensation insurance.

The undersigned swears or affirms that he/she is not required to provide workers' compensation insurance under the provisions of Pennsylvania's Workers Compensation Law for one of the following reasons, as indicated:

_____ Contractor with no employees. Contractor prohibited by law from employing any individual to perform work pursuant to this building permit unless contractor provides proof of insurance to the township.

_____ Religious exemption under the Workers Compensation Law.

Subscribed and sworn to before me this _____ day of _____ 19 _____

(Signature of Notary Public)

My commission expires: _____

(Seal)

Signature of Applicant _____

Address _____

County of _____

Municipality of _____

PLEASE ATTACH COPY OF INSURANCE CERTIFICATE!

PARADISE TOWNSHIP BUILDING RESTRICTIONS

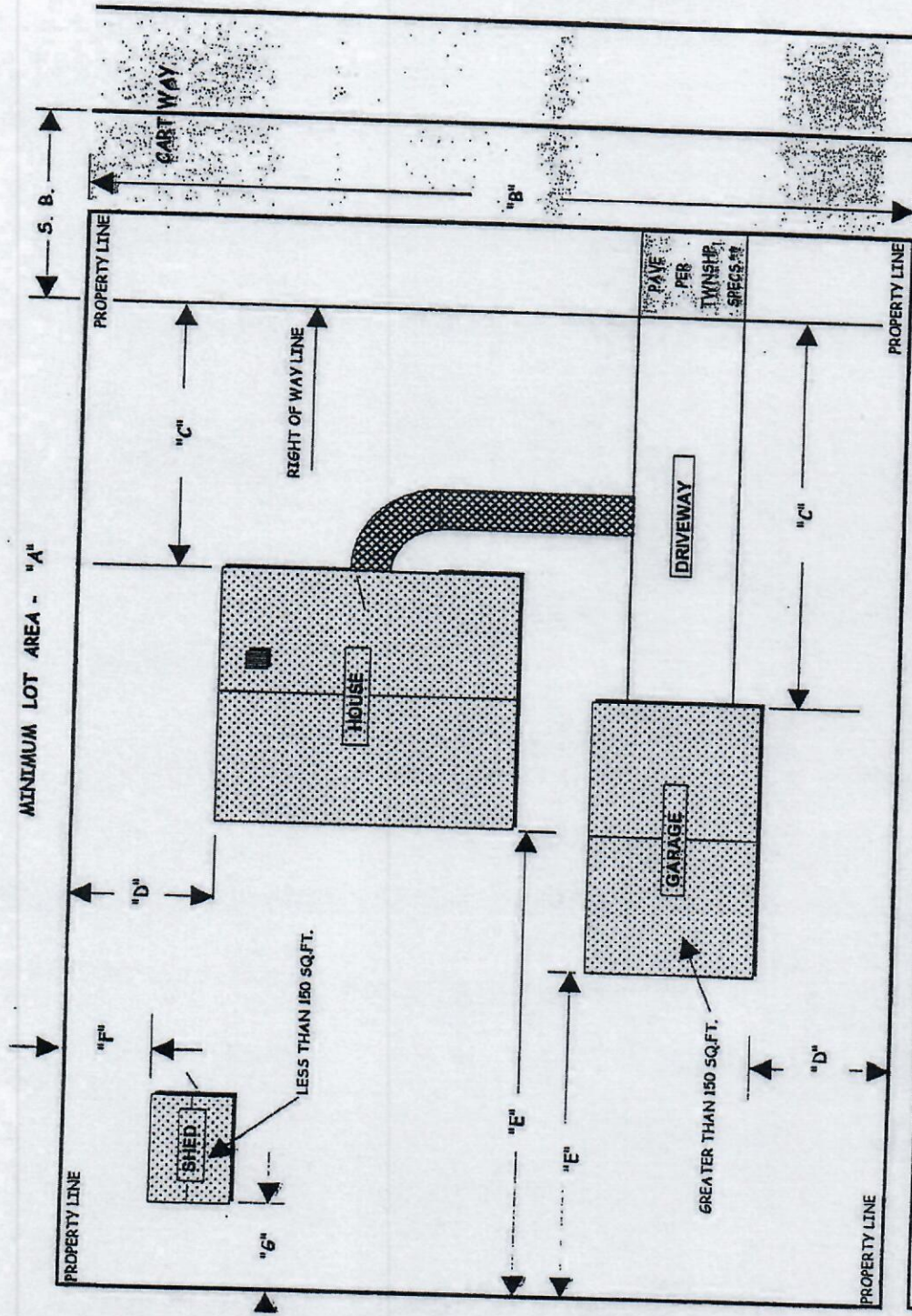

*SEE PART 9 FOR PARKING
 **SEE SECT. 507, SD&LD ORD.

	"A"	"B"	"C"	"D"	"E"	"F"	"G"
	(SQ. FT.)	(FT.)	(FT.)	(FT.)	(FT.)	(FT.)	(FT.)
AGRICULTURAL -	45000	150	50	25	35	10	10
CONSERVATION -	5 ACRES	200	50	50	50	10	10
RESIDENTIAL -	AS SPEC.	AS SPEC.	50	25	35	10	10
COMMERCIAL -	NONE	NONE	50	25	25	10	10
INDUSTRIAL -	40000	150	50*	35	35	35	35

ALLEY	CUL-DE-SAC	LOCAL	COLLECTOR
S. B.	15 FT.	25 FT.	30 FT.

Part 1
Outdoor Swimming Pool

§101. Definition. As used in this Chapter, "swimming pool" or "pool" is an outdoor swimming pool used or intended to be used solely by the owner of a residential property, his family, or lessee thereof and his family, and by guests invited to use it without the payment of any fee. (Ord. 90-2, 2/28/1990)

§102. Applicability. This Part shall apply to all new outdoor swimming pools hereinafter constructed whether aboveground or in the ground and having a depth of eighteen (18") inches or more at any one (1) point. (Ord. 90-2, 2/28/1990)

§103. Construction Permit and Approval.

1. Before any work is commenced on the construction of a swimming pool or on any alteration, addition, remodeling or other improvement to a swimming pool, an application for a permit for construction, together with plans and specification pertinent to the construction, as well as explanatory data, shall be submitted to the Zoning Officer. No part of the work shall be commenced until approval has been granted the applicant by a written permit. The fee for such permit shall be twenty-five (\$25.00) dollars.

2. The plan shall show the location of all buildings and the proposed pool on the property, distances to all property lines in the immediate vicinity of the swimming pool and dwelling, and the location of wells, sewage disposal systems and proposed enclosure or fence around the pool.

3. Standard pools, properly designed by established swimming pool companies and having the approval of a registered engineer or registered architect, shall be acceptable when accompanied by suitable plans and specifications, including information as stated herein.

(Ord. 90-2, 2/28/1990)

§104. Enclosure.

1. Every swimming pool shall be completely surrounded by a fence, wall or similar enclosure not less than four (4') feet in height, which shall be so constructed as to have no openings, holes or gaps larger than two (2") inches in any dimension. If the fence or wall is a picket fence, the horizontal dimensions maintained shall not exceed four (4") inches. A dwelling or accessory building may be used as part of such enclosure.

2. All gates or door openings through such enclosure shall be equipped with a self-closing, self-latching device on the pool side for keeping the gate or the door securely closed at all times when not in use, except that the door of any dwelling or accessory building which forms a part of the enclosure need not be so equipped. The fence shall surround the pool and the deck area. Fences shall be erected around all existing swimming pools no later than July 1, 1990.

(Ord. 90-2, 2/28/1990)

§105. Location on the Property.

1. A swimming pool shall be located at the rear of a dwelling or along the side of the dwelling where practical.
2. There shall be a minimum of three (3') feet of concrete, stone, brick or block sidewalk or other all-weather surface around all pools, except portable above-ground pools.
3. No swimming pool or appurtenances, including decks and shelters, shall be erected nearer to any property line than a building could be erected in the same use district as set forth in the Township Zoning Ordinance [Chapter 27].

(Ord. 90-2, 2/28/1990)

§106. Design and Construction Requirements. No permit to construct new swimming pools, (existing pools are excluded from this Section), shall be issued unless and until the following design and construction requirements are observed.

- A. Material. The material used for lining a swimming pool shall be impervious and shall provide a tight tank with easily cleaned surfaces. Sand or dirt bottoms are prohibited if uncovered.
- B. Walls and Bottom. All pool walls and bottom shall be designed to withstand water pressure from within and to resist the pressure of earth or ground water when the pool is empty.
- C. Make-up Water. Pools shall be equipped with suitable facilities for adding make-up water as required. There shall be no physical connection between the water supply line and the pool system. When make-up water is added to the pool, the inlet shall be at least six (6") inches above the pool water surface.
- D. Drainage Outlet. No pool water shall be drained at the curb, along the gutter line or any street or on the surface of any street.
- E. Recirculation. Provision shall be made for complete circulation of water throughout the pool. The system shall be designed and constructed so that a turnaround at least once [in] every twelve (12) hour period shall be provided. Recirculation systems shall consist of pumping equipment, hair-and-lint catcher, filters, together with all necessary pipe connections to the pool inlets and outlets, facilities and pipe connections necessary for backwashing or cleaning filters.
- F. Safety Equipment. Life preservers, ropes and poles shall be readily available at the pool side.

(Ord. 90-2, 2/28/1990)

§107. Portable Pools.

1. Above-ground pools are not subject to the fee schedule nor the design and requirements as set forth herein. However, all such pools having walls less than four (4') feet shall be enclosed in accordance of this Part.
2. Portable above-ground pools having walls four (4') feet or greater in height may be excluded from the fencing requirement provided such pools

are equipped with access ladders which may be raised and locked in a near vertical position when the pool is unattended. An above-ground pool as described in this subsection which is served by a ladder or steps which cannot be raised and locked so as to prevent access by small children shall be enclosed in accordance with §103.

(Ord. 90-2, 2/28/1990)

§108. Property Rights. No swimming pool shall be so located or maintained as to interfere unduly with the enjoyment of the property rights of others. (Ord. 90-2, 2/28/1990)

§109. Shielding Lights. Lights used to illuminate any swimming pool shall be so arranged as to reflect light away from adjoining premises. (Ord. 90-2, 2/28/1990)

§110. Unnecessary Noise. It shall be unlawful for any person to make, continue or cause to be made or continued at any swimming pool, any loud, unnecessary or unusual noise which disturbs, injures or endangers the comfort, health, peace or safety of others. The use or operation of any radio, musical instrument, phonograph, recording equipment, or other machine or device for the producing or reproducing of sound in such manner as to disturb the peace, quiet and comfort of neighboring inhabitants or at any time with volume louder than is necessary for convenient hearing of persons at the swimming pool site shall be unlawful. (Ord. 90-2, 2/28/1990)

§111. Electrical Connections.

1. All electrical installations shall conform to the specifications of the National Electrical Code. No electric wires or conductors shall cross, either overhead or underground, on any part of a swimming pool, nor shall any electric wiring be installed parallel to any pool wall closer than five (5') feet, if underground, unless enclosed in a rigid conduit, or within five (5') feet, if overhead.

2. All underwater lights must be watertight, self-contained units with ground connections running from a waterproof junction box to a proper grounding facility or medium. All underground electric wires supplying current to said lights within a distance of five (5') feet of the pool wall or walls shall be enclosed in rigid conduits.

3. All metal fences, enclosures or railings, near or adjacent to a swimming pool, which might become electrically charged as a result of contact with broken overhead conductors, or from any other cause, shall be effectively grounded.

(Ord. 90-2, 2/28/1990)

§112. Penalties. Any person, firm or corporation who shall violate any provision of this Section shall, upon being found liable thereof in a civil enforcement proceeding commenced by Paradise Township, pay a fine not exceeding one hundred (\$100.00) dollars for the first such offense, or a fine

Editor's Note: Please see Chapter 1, Part 6, "Criminal Enforcement Amendments."

of not more than three hundred (\$300.00) dollars for the second such offense, or a fine of not more than six hundred (\$600.00) dollars for each succeeding offense, plus all court costs, including reasonable attorney's fees incurred by Paradise Township. Northern York County Regional Police Department, the appropriate enforcement officers of Paradise Township, or other appropriate officer or officers of Paradise Township shall have the power to enforce the provisions of this Part. The amount of the fine imposed for the violation of this Part shall be established by the officer who determines that a violation has occurred. Notice of the violation of the Part and the amount of the fine imposed shall be given by personal delivery or by certified mail to the person or entity violating the Part. If the person or entity violating the Part fails or refuses to pay the fine imposed within the period specified within the notice of the violation of the ordinance, the Township, or an officer thereof, shall file a civil enforcement proceeding with the district justice of the peace to enforce the fine imposed. Any violation of this Part shall be deemed a separate offense for each and every day such violation shall continue and shall subject the violator thereof to the penalties above imposed for each and every separate offense. (Ord. 90-2, 2/28/1990; as amended by Ord. 1996-3, 11/11/1996, §2)

APPENDIX G

SWIMMING POOLS, SPAS AND HOT TUBS

(The provisions contained in this appendix are not mandatory unless specifically referenced in the adopting ordinance.)

SECTION AG101 GENERAL

AG101.1 General. The provisions of this appendix shall control the design and construction of swimming pools, spas and hot tubs installed in or on the lot of a one- or two-family dwelling.

AG101.2 Pools in flood hazard areas. Pools that are located in flood hazard areas established by Table R301.2(1), including above-ground pools, on-ground pools and in-ground pools that involve placement of fill, shall comply with Sections AG101.2.1 or AG101.2.2.

Exception: Pools located in riverine flood hazard areas which are outside of designated floodways.

AG101.2.1 Pools located in designated floodways. Where pools are located in designated floodways, documentation shall be submitted to the *building official*, which demonstrates that the construction of the pool will not increase the design flood elevation at any point within the *jurisdiction*.

AG101.2.2 Pools located where floodways have not been designated. Where pools are located where design flood elevations are specified but floodways have not been designated, the applicant shall provide a floodway analysis that demonstrates that the proposed pool will not increase the design flood elevation more than 1 foot (305 mm) at any point within the *jurisdiction*.

SECTION AG102 DEFINITIONS

AG102.1 General. For the purposes of these requirements, the terms used shall be defined as follows and as set forth in Chapter 2.

ABOVE-GROUND/ON-GROUND POOL. See "Swimming pool."

BARRIER. A fence, wall, building wall or combination thereof which completely surrounds the swimming pool and obstructs access to the swimming pool.

HOT TUB. See "Swimming pool."

IN-GROUND POOL. See "Swimming pool."

RESIDENTIAL. That which is situated on the premises of a detached one- or two-family dwelling or a one-family townhouse not more than three stories in height.

SPA, NONPORTABLE. See "Swimming pool."

SPA, PORTABLE. A nonpermanent structure intended for recreational bathing, in which all controls, water-heating and water-circulating equipment are an integral part of the product.

SWIMMING POOL. Any structure intended for swimming or recreational bathing that contains water over 24 inches (610

mm) deep. This includes in-ground, above-ground and on-ground swimming pools, hot tubs and spas.

SWIMMING POOL, INDOOR. A swimming pool which is totally contained within a structure and surrounded on all four sides by the walls of the enclosing structure.

SWIMMING POOL, OUTDOOR. Any swimming pool which is not an indoor pool.

SECTION AG103 SWIMMING POOLS

AG103.1 In-ground pools. In-ground pools shall be designed and constructed in conformance with ANSI/NSPI-5 as listed in Section AG108.

AG103.2 Above-ground and on-ground pools. Above-ground and on-ground pools shall be designed and constructed in conformance with ANSI/NSPI-4 as listed in Section AG108.

AG103.3 Pools in flood hazard areas. In flood hazard areas established by Table R301.2(1), pools in coastal high hazard areas shall be designed and constructed in conformance with ASCE 24.

SECTION AG104 SPAS AND HOT TUBS

AG104.1 Permanently installed spas and hot tubs. Permanently installed spas and hot tubs shall be designed and constructed in conformance with ANSI/NSPI-3 as listed in Section AG108.

AG104.2 Portable spas and hot tubs. Portable spas and hot tubs shall be designed and constructed in conformance with ANSI/NSPI-6 as listed in Section AG108.

SECTION AG105 BARRIER REQUIREMENTS

AG105.1 Application. The provisions of this chapter shall control the design of barriers for residential swimming pools, spas and hot tubs. These design controls are intended to provide protection against potential drownings and near-drownings by restricting access to swimming pools, spas and hot tubs.

AG105.2 Outdoor swimming pool. An outdoor swimming pool, including an in-ground, above-ground or on-ground pool, hot tub or spa shall be surrounded by a barrier which shall comply with the following:

1. The top of the barrier shall be at least 48 inches (1219 mm) above *grade* measured on the side of the barrier which faces away from the swimming pool. The maximum vertical clearance between grade and the bottom of

APPENDIX G

- the barrier shall be 2 inches (51 mm) measured on the side of the barrier which faces away from the swimming pool. Where the top of the pool structure is above grade, such as an above-ground pool, the barrier may be at ground level, such as the pool structure, or mounted on top of the pool structure. Where the barrier is mounted on top of the pool structure, the maximum vertical clearance between the top of the pool structure and the bottom of the barrier shall be 4 inches (102 mm).
2. Openings in the barrier shall not allow passage of a 4-inch-diameter (102 mm) sphere.
 3. Solid barriers which do not have openings, such as a masonry or stone wall, shall not contain indentations or protrusions except for normal construction tolerances and tooled masonry joints.
 4. Where the barrier is composed of horizontal and vertical members and the distance between the tops of the horizontal members is less than 45 inches (1143 mm), the horizontal members shall be located on the swimming pool side of the fence. Spacing between vertical members shall not exceed $1\frac{3}{4}$ inches (44 mm) in width. Where there are decorative cutouts within vertical members, spacing within the cutouts shall not exceed $1\frac{3}{4}$ inches (44 mm) in width.
 5. Where the barrier is composed of horizontal and vertical members and the distance between the tops of the horizontal members is 45 inches (1143 mm) or more, spacing between vertical members shall not exceed 4 inches (102 mm). Where there are decorative cutouts within vertical members, spacing within the cutouts shall not exceed $1\frac{3}{4}$ inches (44 mm) in width.
 6. Maximum mesh size for chain link fences shall be a $2\frac{1}{4}$ -inch (57 mm) square unless the fence has slats fastened at the top or the bottom which reduce the openings to not more than $1\frac{3}{4}$ inches (44 mm).
 7. Where the barrier is composed of diagonal members, such as a lattice fence, the maximum opening formed by the diagonal members shall not be more than $1\frac{3}{4}$ inches (44 mm).
 8. Access gates shall comply with the requirements of Section AG105.2, Items 1 through 7, and shall be equipped to accommodate a locking device. Pedestrian access gates shall open outward away from the pool and shall be self-closing and have a self-latching device. Gates other than pedestrian access gates shall have a self-latching device. Where the release mechanism of the self-latching device is located less than 54 inches (1372 mm) from the bottom of the gate, the release mechanism and openings shall comply with the following:
 - 8.1. The release mechanism shall be located on the pool side of the gate at least 3 inches (76 mm) below the top of the gate; and
 - 8.2. The gate and barrier shall have no opening larger than $\frac{1}{2}$ inch (12.7 mm) within 18 inches (457 mm) of the release mechanism.
 9. Where a wall of a *dwelling* serves as part of the barrier, one of the following conditions shall be met:
 - 9.1. The pool shall be equipped with a powered safety cover in compliance with ASTM F 1346; or
 - 9.2. Doors with direct access to the pool through that wall shall be equipped with an alarm which produces an audible warning when the door and/or its screen, if present, are opened. The alarm shall be listed and *labeled* in accordance with UL 2017. The deactivation switch(es) shall be located at least 54 inches (1372 mm) above the threshold of the door; or
 - 9.3. Other means of protection, such as self-closing doors with self-latching devices, which are *approved* by the governing body, shall be acceptable as long as the degree of protection afforded is not less than the protection afforded by Item 9.1 or 9.2 described above.
 10. Where an above-ground pool structure is used as a barrier or where the barrier is mounted on top of the pool structure, and the means of access is a ladder or steps:
 - 10.1. The ladder or steps shall be capable of being secured, locked or removed to prevent access; or
 - 10.2. The ladder or steps shall be surrounded by a barrier which meets the requirements of Section AG105.2, Items 1 through 9. When the ladder or steps are secured, locked or removed, any opening created shall not allow the passage of a 4-inch-diameter (102 mm) sphere.
- AG105.3 Indoor swimming pool.** Walls surrounding an indoor swimming pool shall comply with Section AG105.2, Item 9.
- AG105.4 Prohibited locations.** Barriers shall be located to prohibit permanent structures, *equipment* or similar objects from being used to climb them.
- AG105.5 Barrier exceptions.** Spas or hot tubs with a safety cover which complies with ASTM F 1346, as listed in Section AG107, shall be exempt from the provisions of this appendix.

SECTION AG106 ENTRAPMENT PROTECTION FOR SWIMMING POOL AND SPA SUCTION OUTLETS

- AG106.1 General.** Suction outlets shall be designed and installed in accordance with ANSI/APSP-7.

ABOVE GROUND POOL COMMON VIOLATIONS

Pool-associated motors shall be connected to an insulated copper equipment grounding conductor not smaller than 12 AWG. Where the branch circuit supplying the motor is installed in the interior of a one-family dwelling or in the interior of accessory buildings associated with a one-family dwelling, using a cable wiring method permitted by Table E4202.1 2009 International Residential Code

Receptacles that provide power for water-pump motors or other loads directly related to the circulation and sanitation system shall be permitted to be located between 6 feet and 10 feet from the inside walls of pools and outdoor spas and hot tubs, and, where so located, shall be single and of the locking and grounding type and shall be protected by ground-fault circuit interrupters. Other receptacles on the property shall be located not less than 6 feet from the inside walls of pools.

All 15- and 20-ampere, single phase, 125-volt receptacles located within 20 feet of the inside walls of pools shall be protected by a ground-fault circuit-interrupter. Outlets supplying pool pump motors from branch circuits with short-circuit and ground-fault protection rated 15 or 20 amperes, 125 volt or 240 volt, single phase, whether by receptacle or direct connection, shall be provided with ground-fault circuit-interrupter protection for personnel.

All metallic parts of the pool structure, including reinforcing metal shall be bonded.

The pool water shall be intentionally bonded by means of a conductive surface area not less than 9 square inches installed in contact with the pool water. This bond shall be permitted to consist of parts that are required to be bonded in Section E4204.2.

Requirements for barriers, fences, gates and locks are found in Appendix G of the 2009 International Residential Code.